

DOW / GLOVER

Block 12, Lot10 De Smet Cemetery



Fred Dow farm, ¼ mile east of the Depot, near the site of the Surveyors' House of *By the Shores of Silver Lake*. At the time of the photo, it was the home of Alfred N. Waters. Photo of Illinois reunion picnic, August 1910.

Frederick Neil Dow and his wife, Mary (Glover) Dow are not mentioned in the Little House books, but they have connections to many Little House book characters and events.

Fred Dow came to Kingsbury County in May 1879. In the 50th anniversary edition of the De Smet NEWS, Dow wrote that there had been little rain the year before and almost no snow through the winter. After camping at Lake Henry, he and his party came over the Indian mound south of De Smet (Highway 25 was cut through the Indian mound), and they were able to see Silver Lake from the rise. Dow decided he wanted to file nearby, the little lake being so beautiful. At the time, Lake Henry was dry a quarter mile in from its shoreline, but Silver Lake was full of water.

On June 3, he filed on a tree claim, the SW 27-111-56 (he signed his name *Frederic Dow* in all claim filings); his father, James Dow, filed on a tree claim a half mile east of his son, the SW 26-111-56. He was the only person filing near the townsite ahead of the Cameron gang, land swindlers who scooped up land around railroad townsites as soon as locations were announced. He returned to St. Charles, Minnesota for the winter, but was

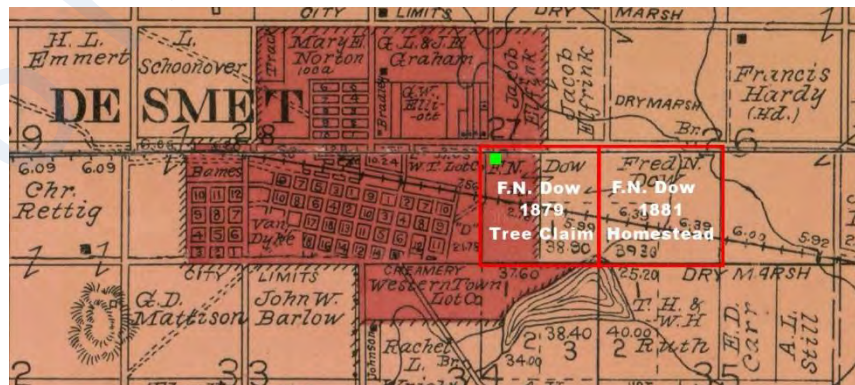

Tree claims of Fred Dow and his father, James Dow. The Surveyor's House stood on the southeast part of Fred Dow's claim. It is not known where Dow built his sod house, but the house shown in the photo above was located on the northwest corner of the land, today at the southeast intersection of Lyle Avenue NE and Front Street NE.

contacted there (one wonders how they knew where he was and how he was contacted) and asked if he would give up his land for the residence blocks of De Smet, the idea being that the main business blocks would be located just north of Silver Lake. Dow refused to sell or trade, even after being threatened that the town would locate the town miles away from his claim if he didn't cooperate.

Returning to De Smet in April 1880, Fred Dow thought his claim had been jumped, as there was a shanty on his tree claim – the Surveyors' House, and a family living in it – the Ingallses. In August 1879, the Dakota Central Railroad had secured a 100-yard right-of-way through both Dow parcels. Dow built a sod house and barn, one of the few sod houses in the area, he recalled. Although not the usual practice, half of Dow's tree claim was incorporated into the village of De Smet, as shown in the map.

FREDERICK NEIL DOW

Block 12, Lot 10 De Smet Cemetery
January 24, 1857 – January 19, 1940; died at age 83

Husband of Mary (Glover) Dow; married October 22, 1885.
Father of Lillian (1893), Freda (1895), and Margaret (1906).

Frederick Neal Dow was born in Livermore Falls, Maine, on January 24, 1857, the son of James Chase Dow (1818-1899) and Hannah Gould (Bacon) Dow (1825-1905). He was a brother of Edwin Ruthven Dow, who married Mary Cooley, sister of *On the Way Home's* Frank Cooley.

Another brother, James Jabez Dow, was head of the blind school in Faribault, Minnesota, and named his daughter Mary Amelia.

His arrival and settlement in De Smet is recorded above, and once settled on his tree claim, Dow put in a crop on his land each year for over fifty years. During the Hard Winter, Dow was in De Smet until December 11, taking the last train east to Minnesota. He spent the next few months shoveling snow for the railroad, trying to open the railroad into Dakota. He returned to De Smet on the second train into town on the cleared road, arriving May 18.

On October 22, 1885, Fred married Mary Glover, sister of some of Laura Ingalls' students in the Wilkin School:

DOW, FREDERICK N. to MARY L. GLOVER; 22 Oct 1885; at res. bride's parents in DeSmet; Rev. E. Brown.

The couple had three daughters born in De Smet: Lillian J. Dow (born November 1893), Freda Neal Dow (born November 23, 1895; she married Harold M. Luetscher in Madison), and Margaret Mary Dow (born May 23, 1906; she married Ellis J. Leslie in Windom, Minnesota). Living in town (half his claim was declared as in the city limits of De Smet), Dow took an active part in the building up of the town. The racetrack used by the De Smet Driving Association was built on Dow land in 1887; the first steam



DOW / Frederick N. 1857-1940 / Mary G. 1869-1973

threshing machine was tested on his crop in 1888; and in 1893, he was appointed chief of police and street commissioner.

In 1906, Dow sold some of his De Smet holdings and moved his family to Milwaukee, but he returned annually to harvest his crops. In 1911, the family moved to Madison to be near a daughter in school. The family also lived in Winona, Minnesota, and Daytona, Florida, always returning to De Smet and the Dow lands, which equaled five quarter sections by 1920, when the entire family returned to De Smet to settle in a house on Second Street.

January 25, 1940. The De Smet NEWS.

F.N. Dow Death Took Pioneer, Long A Farmer.

Took Claim In 1879, Put In Crop 56 Years, Including Last Season.

Death came early Friday morning to F.N. Dow of De Smet, a pioneer of the vicinity, at the age of almost 83 years, after an illness of two months.

One of the few remaining pioneers of '79, Mr. Dow had spent most of the succeeding years here, a resident of the city but operating farm land. He likely had a record in having put in a crop for 56 years.

Surviving are his wife and three daughters, Miss Lillian Dow of Negaunee, Mich., Mrs. Harold Luetscher (Fredda) of Madison, Wis., and Mrs. Ellis J. Leslie (Margaret) of Windom, Minn. There are two grandchildren, Dow Luetscher and Frederick Leslie. Of his own family two sisters and a brother remain, Marie Doolittle of Chicago, Julia Dow of Los Angeles, Calif., and Edwin Dow of Flagler Beach, Florida.

An adventurous spirit brought Mr. Dow to Dakota Territory in his younger years, and throughout his life he was rugged, full of spirit, devoted to his farm interests and his family, independent in his thought and action. His home and yard were well kept, neat and trim, and for years he had an immense old fashioned flower bed there.

Frederick Neil Dow was born in Livermore Falls, Maine, January 24, 1857. When he was eight years of age his parents moved to St. Charles, Minn., and he grew to manhood there.

In May of 1879, before settlement was general in Kingsbury County, he traveled over this area and selected a claim on the north side of Silver Lake, which he described as the most beautiful body of water he had seen in his trip, in that dry year. He filed on the land in June and went back to St. Charles.

While back in Minnesota that fall, Mr. Dow was approached to sell his land for part of the townsite, the plan being to make the main business street three blocks east of where it came to be located, and to have the residential section to the east of that. Mr. Dow wouldn't sell.

By April 20, 1880, Mr. Dow was back here, to build his shack and begin residence, so he saw De Smet grow almost from the first few buildings. On October 22, 1885, he was married to Mary Glover. They developed their farm over a period of years, with a good farmstead and large grove of trees, and sold it in the early 1900s to A.N. Waters. The family lived some years in Milwaukee and Madison, Wis., then at Winona, Minn., and returned here to live in town, he operating land he had bought southwest of the city, which he continued to do through the past season.

MARY L. (GLOVER) DOW

Block 12, Lot10 De Smet Cemetery
May 12, 1869 – April 19, 1973; died at age 103.

Daughter of James Glover and Margaret (Allen) Glover of Ireland.

Sister of Andrew and Jessie. Sister of Martha, William, and Samuel, Laura Ingalls' students in the Wilkin School.

Wife of Frederick Neal Dow; they married October 22, 1885.

Mother of Lillian (1893), Freda (1895), and Margaret (1906).



Mary Glover Dow

Mary Glover came to America from Ireland as a toddler with her parents and brother Andrew. They settled first in Pennsylvania, then Iowa, coming to Kingsbury County in 1882, when James Glover filed on a homestead about two miles northwest of De Smet, the SE 17-111-56. James Glover's sister, named Margaret like their mother, had married George Moody in Ireland and came to De Smet at the same time. George Moody worked with Alfred Waters in the land business.

James and Margaret Glover had six children: Andrew (1867), Mary (1869), Martha (1870), William (1874), Samuel (1879), and Jessie (1880). When Laura Ingalls taught the Wilkin School in April, May, and June 1885, Mary Glover was no longer in school. The Glover students called "Jimmie, Mamie, and Danny" in *Pioneer Girl* were actually Willie, Martha, and Sammy. William Glover was eleven in 1885; Martha was 15; and Samuel was six years old.

In October 1891, James Glover sold his farm and household goods and the family moved to Milwaukee. Andrew and Jessie (born in 1880) were living with their parents in 1900, and Margaret and James Glover were still listed in the 1925 Milwaukee city directory, as was Samuel (married to Tillie), who was a railroad engineer as an adult.

In her later years, Mary Glover Dow lived in the nursing home in Lake Preston.

April 26, 1973. The De Smet NEWS. [photo]

Life's End Comes at 103 for Mrs. Fred Dow, Oldest Resident County.

Death that came Thursday to Mrs. Fred N. Dow ended a life of nearly 104 years to the widow of one of the earliest settlers of Kingsbury County, who homesteaded the quarter section just east of De Smet City in 1879.

Most of the years of Mrs. Dow had been spent in De Smet and vicinity, her last years as a resident of the Manor at Lake Preston where death came on Thursday.

Funeral services were held at Ketelsen-Osthus Funeral Chapel at De Smet Monday at 10 a.m., conducted by the Rev. Carl Evans, pastor of the United Methodist Church of this city. Interment was beside her husband at De Smet Cemetery.

Surviving Mrs. Dow are two daughters, Mrs. Harold (Fredda) Luetscher of Dunedin, Fla., and Mrs. Ellis (Margaret) Leslie of Madison, Wis.; three grandsons and six great-grandchildren. Mr. Dow died in 1940, a daughter also preceding her mother; also two brothers and two sisters.

Mary Glover was born in Belfast, Ireland, May 12, 1869, to Mr. and Mrs. James Glover, and came to the United States at the age of two; her parents settling in Pittsburg, Pa., later moving to Iowa, where they spent some time before coming to De Smet, Dakota Territory.

Mr. Dow visited this area the summer of 1879 and filed on the section just east of the city limits of De Smet, returning to Winona, Minn., for the winter. It was there he was visited by representatives of the Chicago & Northwestern Railway, wishing to purchase his land for a site for De Smet, but he refused.

Marriage for Mary Glover and Fred Dow came October 22, 1885, at De Smet. They made their home on the farm, the residence later moved across the road to the north by A.N. Waters, a later owner.

Organist for the serves Monday was Mrs. James Penney; soloist, Myron Johnson.

Casketbearers were Wendel Johnson, Merle Pratt, Henry Kruger, D. Wayne Meyer, Fred Gehm and Homer M. Nelson.